

1 2 3 4 5 6

A

B

C

D

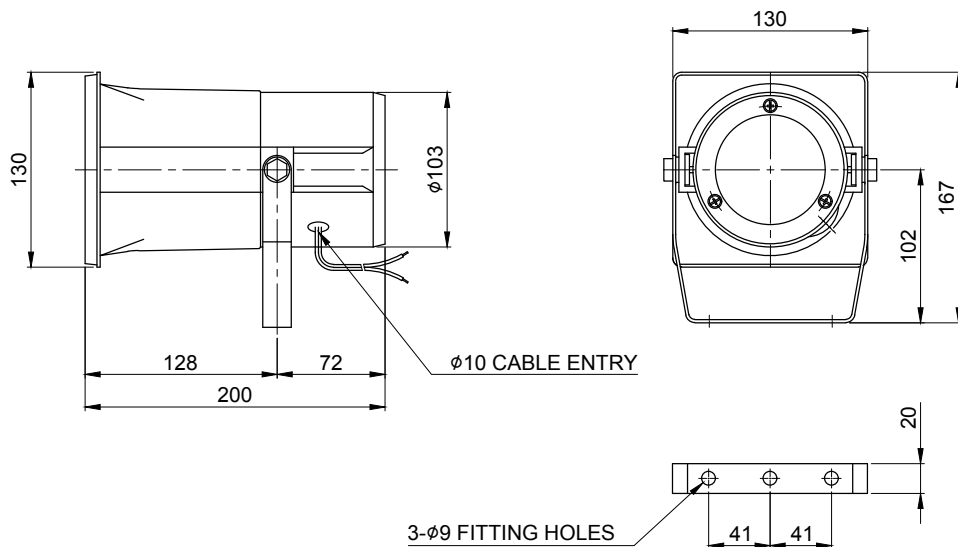

MARK	DATE	REVISION	REVISER	APP .BY
①				
②				
③				

MODEL NO		SEN15/ 25					
MATERIAL		HOUSING-ABS					
		MODEL	SEN15			SEN25	
USE VOLT.	CURRENT	DC12V	MAX. 0.370A		2.211A		
		DC24V			1.022A		
		AC110V	0.080A		0.226A		
		AC220V	0.040A		0.113A		
VOLUME		MAX. 108dB					
PROTECTION GRADE		WATER & DUST PROOF IP55					
CABLE ENTRY		ø10 LEAD HOLE					
COLOR		RED					

ISO2768-1 : CLASS OF TOLERANCE						SURFACE FINISH		-	-	-	1	-
FOR LINEAR DIMENSIONS		f	m	(C)	v			Nr.	DWG. NO.	TITLE/ NAME	MAT'L	REFERENCE
	0.5~3	±0.05	±0.1	±0.2	-			DSND BY	CHKD BY	CHKD BY	APRV BY	DATE
	3~6			±0.3	±0.5			S.H.KIM	J.H.PARK		J.K.HAN	VIEW
	6~30	±0.1	±0.2	±0.5	±1							3
	30~120	±0.15	±0.3	±0.8	±1.5							DATE
	120~400	±0.2	±0.5	±1.2	±2.5							2019.03.20
FOR ANGULAR DIMENSIONS	400~1000	±0.3	±0.8	±2	±4			TITLE			MODEL	
	0~10	±1°	±1°30'	±3°				SEN15/ 25			SEN15/ 25	
	10~50	±0°30'	±1°	±2°				OUTLINE DRAWING			DWG. NO.	
	50~120	±0°20'	±0°30'	±1°							SEN15/ 25_OUT	
	120~400	±0°10'	±0°13'	±0°30'							SCALE	SHEET
											N/S	1/1

Qlight

1 2 3 4 5 6 A4(297X210)